

Marley Horizontal Flow Control Valve

10"-12"-14"-16"-18" and 20" Diameter

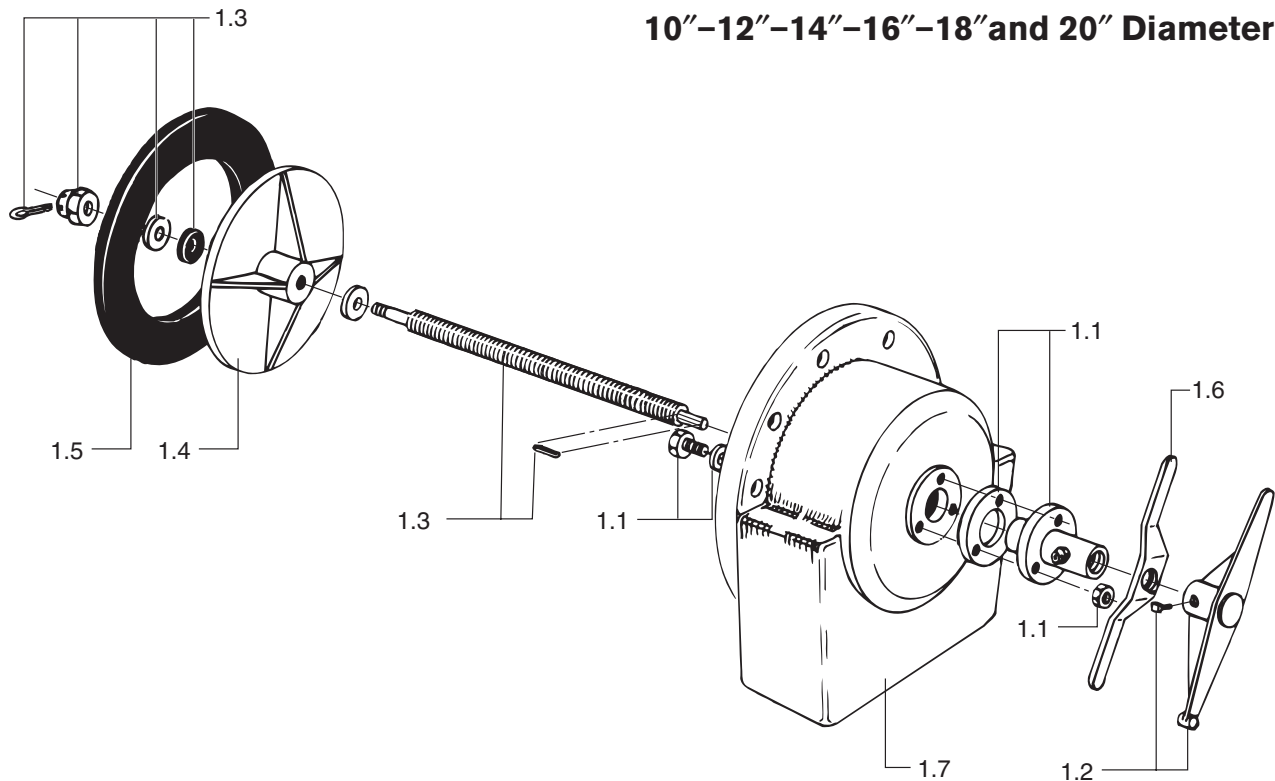

Replacement Parts

- 1.0 Complete Valve Assembly**
- 1.1 Valve stem guide with grease fitting, gasket, and attaching hardware.**
- 1.2 Operating handle with set screw.**
- 1.3 Valve stem with key, washers, resilient washer, castle nut and cotterpin.**
- 1.4 Valve disc.**
- 1.5 Valve body gasket.**
- 1.6 Locking bar.**
- 1.7 Valve body.**

When ordering parts, always provide original Marley order number and tower serial number. Contact the Marley sales office or Marley representative in your area for assistance.

Assembly Sequence

- 1—Attach valve stem guide and gasket to valve body.
- 2—Place valve disc and washers on valve stem. Install castle nut and tighten to compress resilient washer to $\frac{1}{8}$ " to $\frac{3}{16}$ " thick. Install cotter pin.
- 3—Install valve stem and disc subassembly through valve stem guide. Center valve disc in valve inlet opening by differential tightening of the three valve stem guide machine bolts.
- 4—Install locking bar on valve stem.
- 5—Insert key in valve stem keyway and install operating handle. Tighten set screw against key.
- 6—Grease valve stem threads at grease fitting using rust inhibiting lithium base grease of NLGI No. 2 consistency. Coat exposed valve stem threads with grease.
- 7—After adjusting the flow, set the locking bar in the locked position to stabilize the stem and disc.

SPX

COOLING TECHNOLOGIES

7401 WEST 129 STREET | OVERLAND PARK, KANSAS 66213 UNITED STATES | 913 664 7400 | spxcooling@spx.com | spxcooling.com

In the interest of technological progress, all products are subject to design and/or material change without notice.
©2009 SPX Cooling Technologies, Inc. | Printed in USA

Manual 92-1370